

Drilling Template for Wall Mounting Camera (s) ///

For wall-mounting Camera (s), drill two holes using a 1/4" drill bit and the template below. Insert supplied wall anchors into holes and secure Camera to wall with supplied screws.

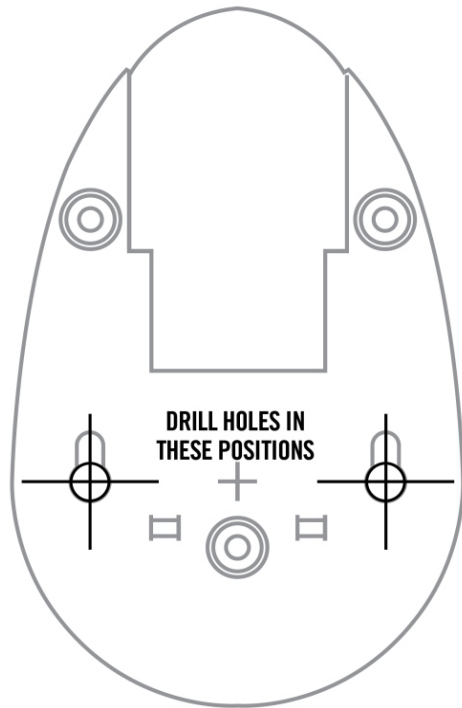

2.4 GHz Wireless Color Baby Camera System

➔ **Includes: Color Video/Audio Camera & LCD Monitor**



Battery (for Monitor)	Voltage	Monitor - 4 * AAA alkaline
	Alkaline Battery	approx. 1 hr. Continuous
Battery (for Camera)	Rechargeable Battery Pack (Optional)	approx. 4 hrs. Continuous > 8 hrs. standby
	Rechargeable Battery Pack (Optional)	approx. 4 hrs. Continuous
General	Operating Temperature	-10°C to 40°C
		14°C to 104°F
	Humidity	Less than 85%

Approvals ///

This device complies with part 15 of the FCC rules. Operation is subject to the following two conditions:

- * This device may not cause harmful interference.
- * This device must accept any interference received, including interference that may cause undesired operation.

CE directive 95/5/EEC, EMC directive 89/336/EEC, LV directive 73/23/EEC. This class B digital apparatus complies with Canadian ICES-003.

Warranty ///

This product has a one year manufacturer's warranty which covers parts and labor only.

Congratulations on your purchase of the 2.4 GHz Wireless Baby Care Color Camera System (CMS3000TS). The System consists of a wireless LCD Monitor and a wireless color day & night Baby Camera. An ideal product for watching the baby, elder or patient.

Features ///

- * 2.4 GHz wireless technology
- * Plug & play installation
- * 2.5 inch TFT-LCD screen for good picture display
- * The Brightness, Color, Contrast, Alarm volume, and Audio volume can be adjusted
- * The system supports up to 3 cameras
- * LCD Monitor can work with 3 modes: Scan, Auto and Manual
- * Monitor with A/V output port connecting to VCR/DVR
- * Baby Camera with sound trigger & night vision
- * Adjustable dwell/cycle time between cameras in Auto mode
- * Both LCD Monitor and Baby Camera can be wall mounted or table top



System Contents ///

Identify all parts before proceeding with installation

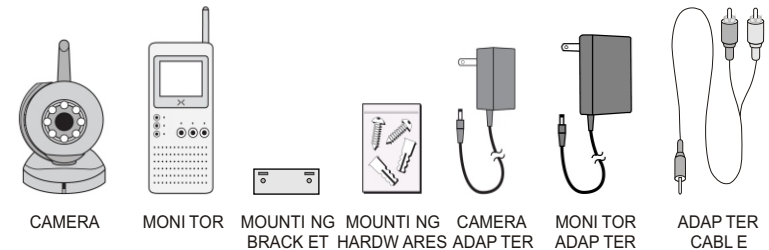

Things to Consider before Installation ///

- For best performance, follow these simple guidelines:
- * The camera should be aimed accordingly to optimize viewing area
 - * For best transmission, avoid installation where there are thick walls or major obstructions between the camera and LCD monitor

Installing the Camera (Transmitter) ///

1. Unpack the Camera
2. Decide on wall or desk mounting the Camera. If wall mounting, there is a useful guide on the back cover of the instructions, and the rechargeable battery pack should not be used then. The Camera head can be rotatable for ideal or required position.
3. To use the 9V camera power adapter, connect power jack to the input on the base of the Camera. Make sure the Camera is positioned no more than 5 feet from an AC power outlet.

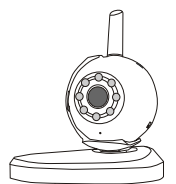

DESK /TABLE TOP

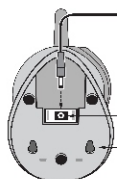

WALL MOUNTED/ CAMERA BASE

CONNECT POWER ADAPTER HERE
KEY HOLES FOR WALL MOUNTING

4. You can adjust the sensitivity for the sound alert feature by adjusting the SOUND TRIGGER dial found on the side of the Camera.

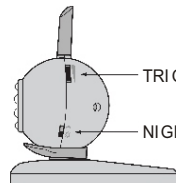

CAMERA SIDE VIEW

TRIGGER SENSITIVITY DIAL
NIGHT VISION ON/OFF SWITCH

4. The Camera (Transmitter) installation is now complete.

Night Vision ///

The Camera includes IR LEDs, which allows viewing up to 5 feet in the dark when used with the adapter. To turn on the IR LEDs, there is a small switch on the side of the Camera. Place the switch adjacent to the moon icon ☾ in order to activate the night vision option. Place the switch adjacent to the sun icon ☀ in order to turn this option off.

2.4 GHz frequency.

Audio problems

1. Ensure the volume is turned up sufficiently on the monitor.
2. Make sure the sound is within the microphone range.
3. If the unit emits a loud wailing sound (feeds back), try moving the camera away from the monitor or angle the monitor differently.

Specifications ///

Camera (Transmitter)

TV System	NTSC or PAL standard
Integrated Lens	5.6mm, fixed focus
Resolution	360 horizontal TV lines
Signal/Noise Ratio	48dB
Image Sensor	1/3" CMOS
Min. Illumination	0.1 lux
Current Consumption	150 mA
Frequency Range	2.41~2.47 Ghz
Modulation	FM
Channel Selection	Electronic tuning with PLL
Overall Size	3.75"W * 4.25"H * 2.45"D (95mmW*107mmH*62mmD)

Monitor (Receiver)

Frequency Range	2.41~2.47 Ghz
Current Consumption	350 mA
Channel Selection	Electronic tuning with PLL
Signal/Noise Ratio	38dB

Battery (for Monitor)

Voltage	Monitor - 4 * AAA alkaline
Alkaline Battery	approx. 1 hr. Continuous

ALARM VOLUME

The ALARM VOLUME of the LCD Monitor can be adjusted by tuning the Alarm Volume tuner on the top of the LCD Monitor.

VOLUME

You may adjust the Sound Level by pressing “+” or “-” on the Volume button.

Menu

- * LED on, adjust Brightness +/-
- * LED flashing, adjust Color +/-
- * LED off, adjust Contrast +/-

Trouble Shooting ///

If you are having trouble operating this product, please consult the guide below;

SYMPTOM

REMEDIES

No camera picture

1. Check all connectors. Make sure camera (s) and monitor are switched ON.
2. Ensure camera (s) and monitor are set to correct channel (s).
3. Make sure camera is within range of monitor (receiver).

Blank monitor

1. Make sure monitor is switched ON.
2. If using AC adapter, make sure it is plugged in.
3. Make sure rechargeable battery is charged.

Interference on camera picture

1. Make sure each camera (transmitter) is within range, and that no large obstructions are blocking the signal.
2. Try repositioning the camera, monitor or both to improve the reception quality.
3. Reposition other nearby equipment transmitting on

Installing the LCD Monitor (Receiver) ///

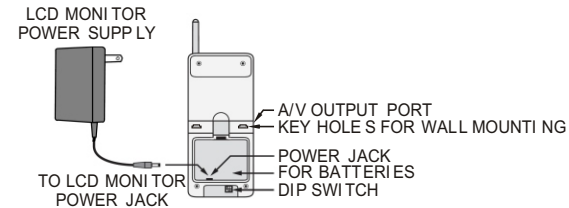

Main Operation

1. Plug the LCD Monitor AC power supply into the power jack in the battery recess of the LCD Monitor.
2. Turn on the LCD Monitor by pressing the top power button.
3. If working with VCR/DVR, connect the LCD Monitor (to its A/V output port) and the VCR/DVR (to its Audio Input & Video Input) with the Adapter Cable.

Optimizing the Wireless Camera System ///

The 2.4 GHz video signals pass easily through your home's interior walls, but the signal may be reflected by power wires or plumbing inside the wall. **Sound Level** can be adjusted using the volume control knob on the top of the Monitor. Adjust **Brightness/Contrast** as required using MENU/+/- button on the panel of the LCD Monitor. The **Sensitivity of Sound Trigger** can be adjusted by Baby Camera's TRIGGER LEVEL dial. The most common source of interference are microwave ovens. Try to avoid mounting the LCD Monitor near a microwave oven or other source of RF interference such as cordless phones.

Multi-camera Operation ///

The Wireless Baby Care Color Camera System (CMS3000TS) is designed to work with up to (3) Cameras. Additional Camera are sold separately.

IMPORTANT:

When using more than one Camera, make sure each Camera is assigned to a specific channel by adjusting the corresponding DIP switch down.

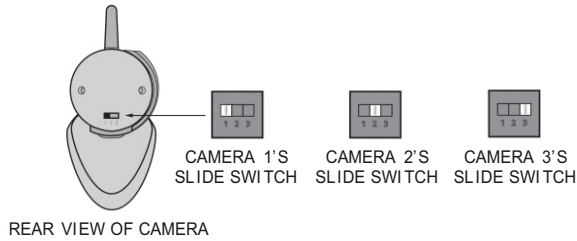

Accordingly the DIP switch located on the back of the LCD Monitor should be adjusted to reflect the channel in use.

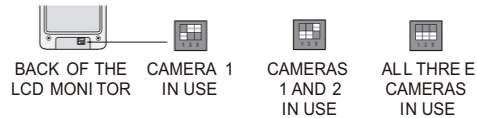

Sound-Trigger Cameras ///

The baby Camera has the **Sound Trigger Feature**. When a Camera detects sound, an audio alert sounds on the LCD Monitor. The Sensitivity of the Sound Trigger can be adjusted by the Baby Camera's TRIGGER LEVEL dial on side of the Camera head.

Operating Modes ///

The system can be set to operate in one of 3 modes: **SCAN**, **AUTO** or **MANUAL**. The desired operating mode can be selected using the buttons on the front panel of the LCD Monitor.

SCAN

Pressing the **SCAN** button places the system in Scan mode. The LCD Monitor screen blanks into a standby mode while the system continuously scans active Cameras. If a Camera detects sound above the preset sound trigger level, the LCD Monitor displays the Camera picture and the beeper will sound. Four minutes after the last detection, the screen returns to standby mode and the LCD Monitor resumes scanning. Pressing the **MANUAL** or **AUTO** button will cancel this mode.

AUTO

Pressing the **AUTO** button places the system in Auto mode. In this mode, the system automatically rotates through all active Cameras. When a Camera detects sound above the preset level, the LCD Monitor will display the picture from the Camera for a few seconds, and the beeper will sound. To avoid searching the channels that do not have cameras/transmitters assigned to them, set the dip switches (located on the back of panel of the LCD Monitor) for those corresponding channels to the **OFF** position.

The dwell/cycle time (time taken to switch between cameras) is preset to four seconds and can be adjusted between 2-30 seconds. To adjust the dwell/cycle time, press both the **AUTO** and **MANUAL** buttons simultaneously. Each flash of the LED increases the dwell time by one second.

MANUAL

To select a specific Camera to LCD Monitor, press the **MANUAL** button. The LCD Monitor will switch to a different Camera each time the **MANUAL** button is pressed. To avoid searching channels that do not have Cameras assigned to them, set the dip switches (located on the back panel of the LCD Monitor) for those corresponding channels to the **OFF** position.

Monitor Functions ///

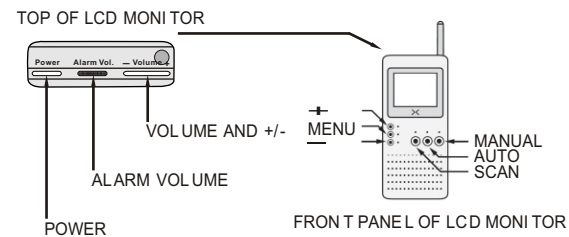

POWER

Press to turn the Monitor on/off.